

# DISCLOSURE PLAN

## FOR PROPOSED LOT 573

Proposed Lot 573 is currently described as part of Lot 4 on SP332712. Situated at Round Mountain in the locality of New Beith.

### LEGEND

00.00	PAD LEVEL
- - - +1.0 - - -	DESIGN FILL CONTOUR (0.5m INTERVAL)
— 35.0 —	DESIGN F.S.L. SURFACE LEVEL CONTOUR (0.5m INTERVAL)
	AREA OF FILL
	RETAINING WALL

### Note:

For further building requirements see Proposed Round Mountain, New Beith - Precinct B Plan of Development P0055018 / POD-01-POD-03 dated 9 February 2026 by URBS.

### Surveyors Note:

This plan has been prepared by RPS AAP Consulting Pty Ltd (ACN 117 883 173), which is registered with the Surveyors Board of Queensland as a Cadastral Surveyor.

### Builders Note:

Builders shall not build off the design levels shown; a site survey is required. This note is an integral part of this plan.

### Engineering Note:

Engineering design information supplied digitally by Colliers. April 2026.

### Compaction Statement:

All earthworks shall be carried out in Accordance with AS3798 -2007 with a testing regime in accordance with AS2007-1996 Level 1 and further compaction methodology in Accordance with AS3798-1996

### SCALE



<b>Local Authority :</b> Logan City
<b>Height Datum :</b> AHD
<b>Height Origin:</b> PM126832 RL 45.63
<b>Contour Interval :</b> 0.5 m
<b>ENG :</b> 2026-04-29 COLLIERS Precinct B design base (DISC & PHSP)
<b>BDY :</b> I51729 Boundary_ ProjectDatum_20260311
<b>Surveyor:</b> GAJ (PREC B R2)
<b>Drawn :</b> BJB
<b>Scale :</b> 1:200 @ A3
<b>Date:</b> 3 JUNE 2026
<b>Dwg No:</b> I51729-DISC-8b/573

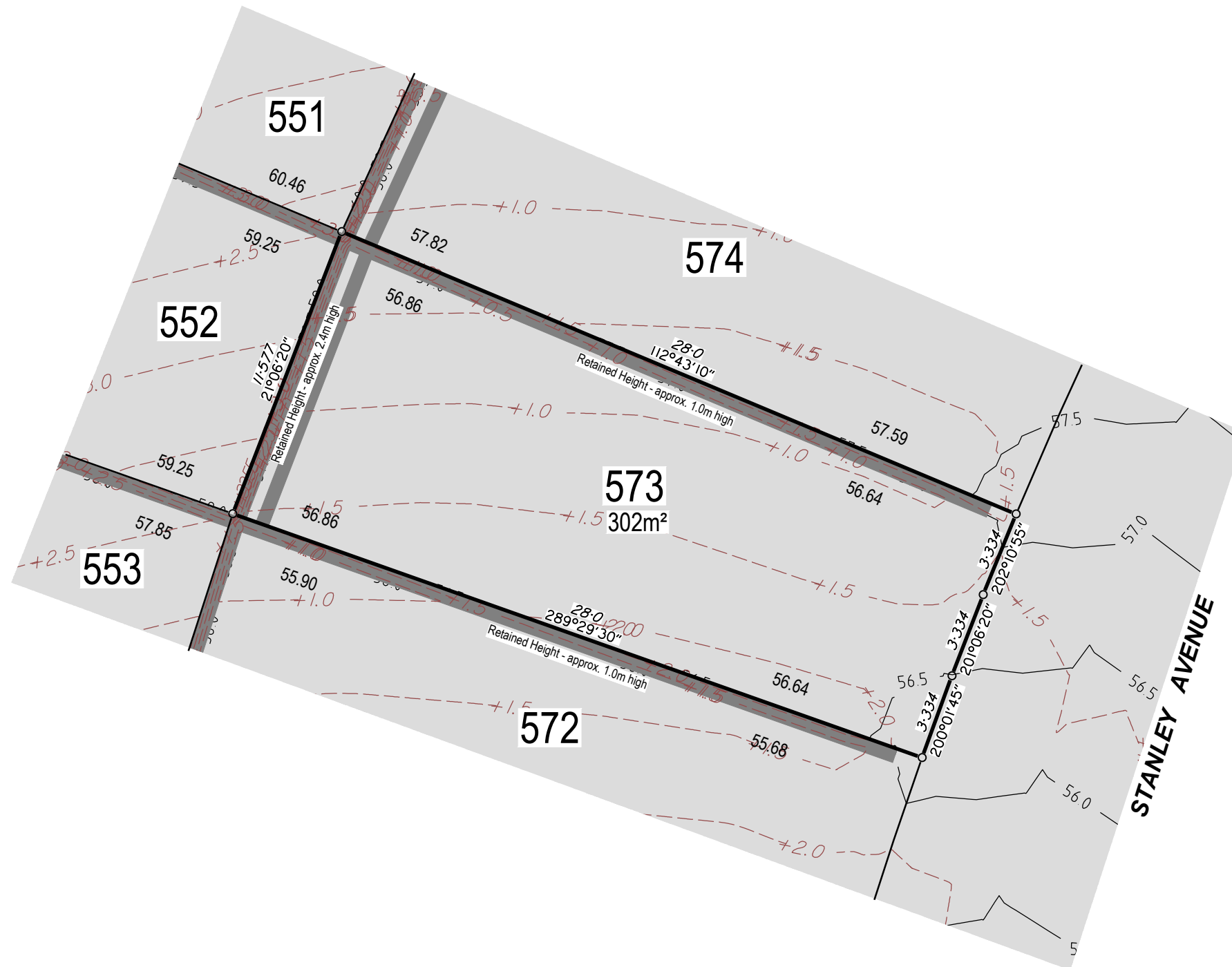

### Note:

This plan has been prepared for FRASERS PROPERTY NEW BEITH Pty Ltd (ACN 655 630 381), for the purpose of a disclosure plan under the Land Sales Act 1984 (as amended) and must not be used for any other purpose.



RPS AAP Consulting Pty Ltd  
ACN 117 883 173  
ABN 97 117 883 173  
Lakeside Corporate Space, Suite 425, Level 2  
Building 4, 34-36 Glenferrie Drive,  
Robina PO Box 1048 Robina DC, Qld 4226

**T** +61 7 555 36900

**F** +61 7 555 36999

**W** rpsgroup.com

© COPYRIGHT PROTECTS THIS PLAN  
Unauthorised reproduction or amendment  
not permitted. Please contact the author.