

**Depth of Fill:**  
This lot is subject to 0.5m of fill.

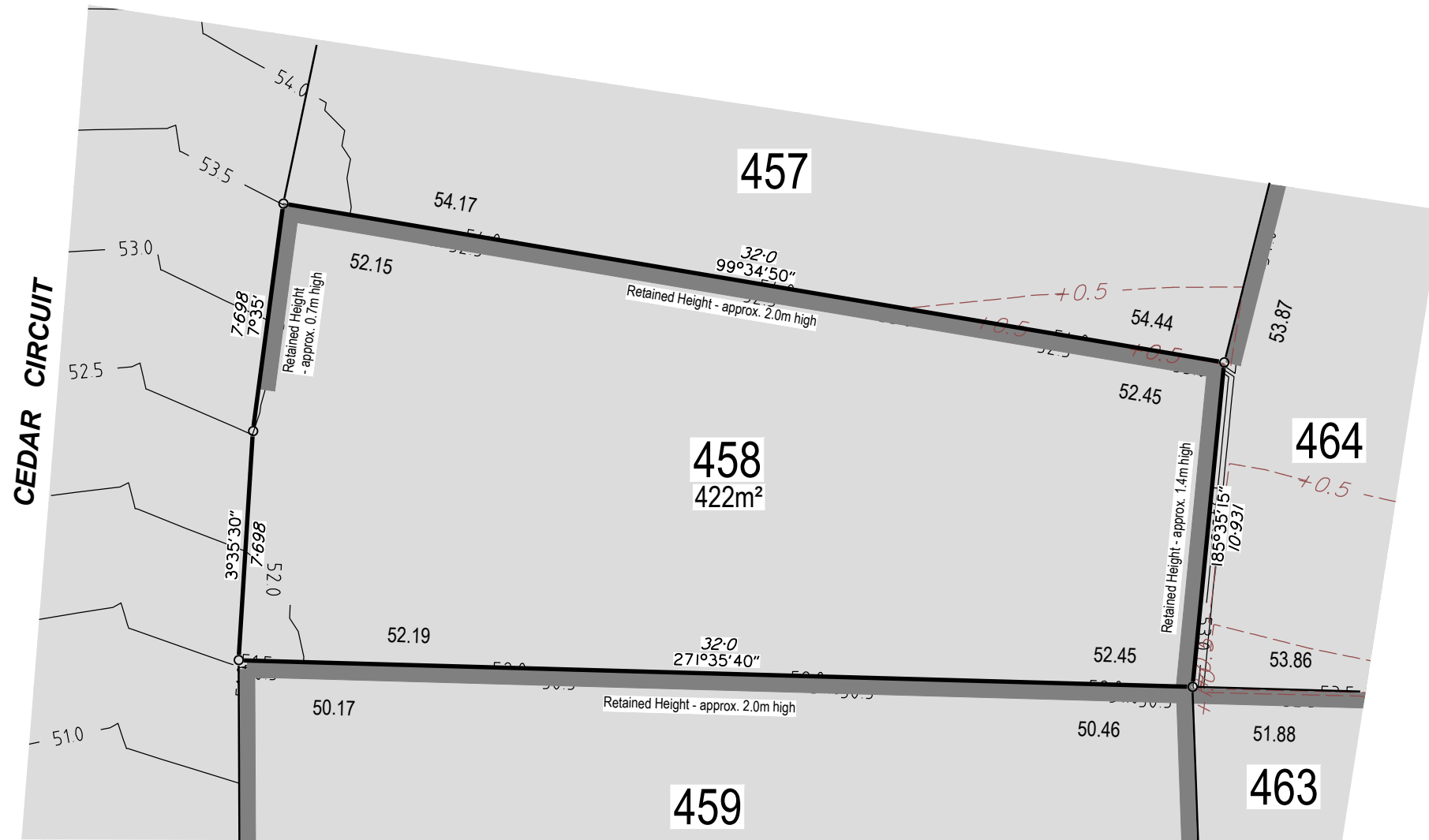

**Note:**  
This plan has been prepared for FRASERS PROPERTY NEW BEITH Pty Ltd (ACN 655 630 381), for the purpose of a disclosure plan under the Land Sales Act 1984 (as amended) and must not be used for any other purpose.



## DISCLOSURE PLAN FOR PROPOSED LOT 458

Proposed Lot 458 is currently described as part of Lot 4 on SP332712. Situated at Round Mountain in the locality of New Beith.

### LEGEND

00.00	PAD LEVEL
---+1.0---	DESIGN FILL CONTOUR (0.5m INTERVAL)
---35.0---	DESIGN F.S.L. SURFACE LEVEL CONTOUR (0.5m INTERVAL)
	AREA OF FILL
	RETAINING WALL

### Note:

For further building requirements see Proposed Round Mountain, New Beith - Precinct B Plan of Development P0055018 / POD-01-POD-03 dated 9 February 2026 by URBS.

### Surveyors Note:

This plan has been prepared by RPS AAP Consulting Pty Ltd (ACN 117 883 173), which is registered with the Surveyors Board of Queensland as a Cadastral Surveyor.

### Builders Note:

Builders shall not build off the design levels shown; a site survey is required. This note is an integral part of this plan.

### Engineering Note:

Engineering design information supplied digitally by Colliers. April 2026.

### Compaction Statement:

All earthworks shall be carried out in Accordance with AS3798 -2007 with a testing regime in accordance with AS2007-1996 Level 1 and further compaction methodology in Accordance with AS3798-1996

### SCALE



<b>Local Authority :</b> Logan City
<b>Height Datum :</b> AHD
<b>Height Origin:</b> PM126832 RL 45.63
<b>Contour Interval :</b> 0.5 m
<b>ENG :</b> 2026-04-29 COLLIERS Precinct B design base (DISC & PHSP)
<b>BDY :</b> I51729 Boundary_ ProjectDatum_20260311
<b>Surveyor:</b> GAJ (PREC B R2)
<b>Drawn :</b> BJB
<b>Scale :</b> 1:200 @ A3
<b>Date:</b> 3 JUNE 2026
<b>Dwg No:</b> I51729-DISC-8b/458



RPS AAP Consulting Pty Ltd  
ACN 117 883 173  
ABN 97 117 883 173  
Lakeside Corporate Space, Suite 425, Level 2  
Building 4, 34-36 Glenferrie Drive,  
Robina PO Box 1048 Robina DC, Qld 4226

**T** +61 7 555 36900

**F** +61 7 555 36999

**W** rpsgroup.com

© COPYRIGHT PROTECTS THIS PLAN  
Unauthorised reproduction or amendment  
not permitted. Please contact the author.